

11 Continue through the Lady Arbour to arrive at the South West Turret. On the south-facing wall of this turret can be seen a corner stone laid by the Fifth Earl of Warwick, Past Deputy Grand Master, on 14th May 1907, “with full Masonic Ceremonial”. Inside the porch of the turret is a decorative frieze and ceiling—both containing various Masonic symbols. The frieze also incorporates head carvings. On the pillars, either side of the porch entrance, are head carvings of King Edward VII (Past Grand Master) and Queen Alexander whilst inside the porch is that of Dr. G.R. Sinclair (Grand and Provincial Grand Organist).



Although not part of the Cathedral trail, it is worth pointing out that Admiral Lord Nelson’s Column on Castle Green, whilst erected by public subscription, has a foundation stone laid by the Freemasons under the aegis of The Palladian Lodge No. 120, on 2nd April 1806. He was a Freeman of the City of Hereford.



We hope that this short journey has proved enjoyable and interesting and that all the items of Masonic reference around the Cathedral have been identified but, should any eagle-eyed of you know otherwise, we would be pleased to include your discovery!

W.Bro. Egerton Parker P.A.G.D.C.
and
W.Bro. John Perris Pr.G.Reg., P.Pr.G.D. (Bucks)

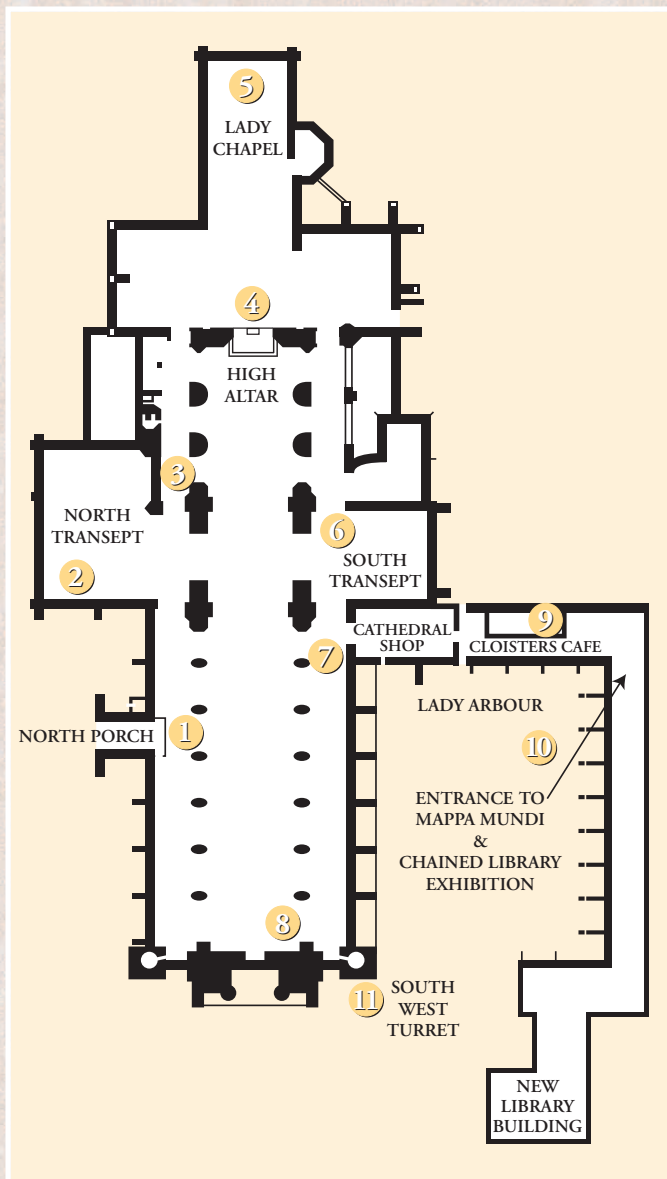

A MASONIC TRAIL AROUND HEREFORD CATHEDRAL



The Trail begins by entering the Cathedral through the North Porch. Whilst there are memorials to other distinguished freemasons in the Cathedral, including Samuel Sebastian Wesley and Rev. Sir Frederick Gore Ouseley, these do not contain any masonic references and have not, therefore, been included in this trail.



1 On the inside of the wooden inner vestibule to the North Porch entrance is a brass plaque, erected on the right hand side in 1925, to the memory of the Hon. James Wentworth Leigh. He was Dean of Hereford Cathedral from 1894 to 1919 and Provincial Grand Master for Herefordshire from 1906 to 1923. Above the doors of the vestibule are displayed various Masonic symbols, including those of Craft, Royal Arch and Mark Masonry.



2 Travelling eastwards into the North Transept you will find a plaque in memory of The Venerable Richard Lane Freer D.D. (1806 to 1863), Archdeacon of Hereford. He was Deputy Provincial Grand Master from 1860 to 1863. Along the base of the adjacent stained glass windows can be found various Masonic symbols and references.



3 A few steps from the North Transept, keen eyes will discover the Mark Master Mason's mark of Sir Percy Hull (Grand Organist and a founder of Vaga Lodge) around the keyhole of the organ loft door.

4 Immediately behind the High Altar is a tablet at the base of the central column. This states that it was restored in memory of Sir Joseph Russell Bailey Bt., M.P., J.P., by his "Brothers and Friends". He was Provincial Grand Master from 1880 to 1906.



5 In 2005 the East Windows were restored by Jim Budd, with the assistance of funds provided by the Grand Charity and the Provincial Grand Lodge of Hereford, the Freemasons thus helping to enhance both the East and the West ends of the Cathedral. There is a magnificently carved slate roundel in the Close, beneath the windows, recording all the relevant masons' marks and also prominently displaying the Square and Compasses.



6 The next Masonic reference can be found on entering the South Transept. On the right hand side is a commemorative plaque to Dr. George Robertson Sinclair (another founder of Vaga Lodge and Grand Organist, also the G.R.S. mentioned in Elgar's Enigma Variations). Whilst the plaque contains no reference to his career in Freemasonry, Masonic symbols are placed in each of the four corners.



7 In the South Aisle, on the wall adjacent to the Bishop's Cloister entrance, will be found a

brass tablet commemorating Wilfred Townshend Carless (born 1875), who was lost in battle at Gallipoli on July 16th 1915. The tablet shows him as being P.Pr.G.St.B. in the Craft and P.Pr.G.S.W. in the Mark.



8 Inside the Cathedral, by the left of the central doorway of the West Front, is found the head/corbel of Dean Leigh, Provincial Grand Master at the time of its opening, after rebuilding during 1904 to 1908.



9 Leave the Cathedral through the doors to the Bishop's Cloister and pass through the Cathedral Shop into the café. On the wall behind the café counter are a number of plaques and wall plates, one of which is to the memory of Sir Percy Hull, once again showing his Mark Mason's mark.



10 Leaving the café by the outside door on the left hand side will take you into the Lady Arbour, which is where Dean Reginald Waterfield lies buried. He was Provincial Grand Master from 1923 to 1947 and Dean of Hereford Cathedral.